



Grades 7/8: May 31-June 4

Grades 5/6: June 5-9

Highland Lakes Camp | Spicewood, TX

PARENT INFORMATION

**The following campuses will check-in and depart from
the ROCKWALL campus:**

ROCKWALL, ROCKWALL ESPAÑOL

**The following campuses will check-in and depart from
the MESQUITE campus:**

**EAST DALLAS, FIREWHEEL, FORNEY, MESQUITE,
NORTH DALLAS, NORTH DALLAS ESPAÑOL**

OVERVIEW

Over two weeks, we will be taking over 1,500 students in grades 5th-8th grade and volunteers from all of our campuses to beautiful Lake Travis near Austin, Texas. Each day will have incredible worship with Move Love Worship Team and guest speakers, Jacob King (5/6 Grade camp) and Nate Gilgenkamp (7/8 Grade camp). Students are assigned to a small group to help walk them through the challenging and powerful messages they will hear.

We know it is going to be an incredible week! Please keep us in your prayers as we experience all that God has in store for us.

- Pray for your student on a daily basis that God would do something incredible in his or her life.
- Pray for the safety of all the students and leaders.
- Pray for the leaders that God would give them energy for each day and wisdom to deal with the issues they will face.

PARENT MEETING INFORMATION

All parent meetings will take place on Sunday, May 19, at your home campus at the following times/locations:

East Dallas	11:30 AM	Gameroom
Firewheel	1:00 PM	Main Auditorium
Forney	1:00 PM	Main Auditorium
Mesquite	1:00 PM	Student Room
North Dallas	12:30 PM	Chapel
North Dallas Español	2:30 PM	Chapel
Rockwall	12:30 PM	Student Building Auditorium (Pier 419)
Rockwall Español	3:30 PM	Student Building Auditorium (Pier 419)

EMERGENCY / CONTACT INFORMATION

In the case of a family emergency, we ask that you contact one of our event leads, Janey Shepherd or Kelly Capps. Emergencies can include any incident regarding health, family crisis or immediate pick-up.

Janey Shepherd | Event Director
469.261.7970

Kelly Capps | Logistics Lead
972.839.1768

Greg Bradford - Central Student Pastor
214.418.6812

CAMP INFORMATION

Highland Lakes Camp & Conference Center

5902 Pace Bend Rd. N.
Spicewood, TX 78669
512.264.1777

STAY UPDATED

Follow United Camp by joining our Lakepointe Students Facebook Group that can be found through the LP Connect Facebook main page or at this link:

<https://www.facebook.com/groups/studentslp/>

Or by downloading our LP Students app

MEDICAL EMERGENCIES

All medical emergencies and sicknesses will be handled on the spot by the medical staff at Highland Lakes Camp. If there is a more serious medical emergency, your child will be taken to a local hospital for treatment and you will be notified immediately.

MEDICATION

Students **must** drop off their medications at check-in. ALL medicine must be in its original prescription bottle with student's name on it. Please don't bring any over the counter medicine as the camp will have anything your child might need in their medical clinic. **Please administer lunch meds as needed prior to student getting on bus at check-in.**

Students will need to come to the medical clinic at the appropriate times during the day to receive medications. If they forget (which we know they will) our staff will track down the student to take them to the clinic.

SECURITY

We have thoughtfully considered and established all of our policies and procedures to keep every student safe while they are in our care. We are bringing our own security team, composed of volunteers.

TRANSPORTATION

We will be traveling to camp on chartered buses. Buses will be split between guys and girls to the best of our ability.

All buses are pre-assigned by group/friends requested. We will have adult leaders spread throughout each bus. We will show rated G or PG only movies on the buses. Once on the bus, students will not be allowed back off the bus until arrival.

All of our buses will be nut free so please keep this in mind when packing bus snacks.

FREE TIME ACTIVITIES

Free time is between lunch and dinner each day.

Highland Lakes Camp has many activities for your student to enjoy which are all included in the cost of camp. These activities include the following and much more!

- Archery
- Basketball
- Zipline
- Gelly Ball
- Blob
- BB Guns
- Paddleboards
- Kayaks
- Large Swimming Pool with 2 Water Slides
- Giant Hexapod
- Banana Boats on the lake if lake levels permit

MISSION EMPHASIS

Every year, we place a special emphasis on a ministry to highlight needs in our world. At camp this year, your student will have an opportunity to impact the lives of kids and students in South Africa. That region has been impacted by a lack of clean water and our camp mission offering will go towards supplying clean water. You can send money with your student to donate to this amazing ministry during camp.

SMALL GROUPS

The leaders in your student's small group will be background checked and trained by the campus Student Pastors. Small groups are campus specific and generally range from 10-12 students, plus adult leaders. Small group time is for discussion on the topics the speaker teaches on during worship sessions.

ROOMING

We are staying in bunk style accommodations. We ask that you have an important conversation with your student about respecting the things in their room. Any damages will be paid for by the student's family.

Dorms will be off-limits during free time and our security team will monitor the areas at all times. Should a student need access to their room, a leader or security member will need to grant them access and arrange for them to be escorted. Once students are in the room for the night, they will not be allowed to leave. Our security team will do a room check on all rooms each night to ensure all students are in their rooms.

We will work as hard as we can to make sure that students room with who they requested, but there are instances where it is necessary to go outside of those requests. We can promise that each room is created thoughtfully and prayerfully and your student will have an amazing week.

WHAT TO BRING

- **Lunch for bus ride to camp**
- One suitcase
- Appropriate clothes (see **packing guidelines** for appropriate wear)
- Swim suit
- Light jacket
- Extra tennis shoes (in case they get wet during recreation time)
- White clothes you don't mind getting color powder on
- Drawstring type backpack, lightweight that you wouldn't mind losing
- Flashlight
- Sunscreen and insect repellent
- Water bottle – Please mark the bottle with the student's name
- One bed pillow
- Bedding (sleeping bag or sheets/blankets)—Please put in a sturdy trash bag that is clearly labeled with student's name on it. Be sure to bring an extra trash bag for the trip home.
- Towels (bathing and swimming) and washcloths as none are provided
- Snacks/water for the bus ride
- Toothbrush & toothpaste, hairbrush, etc.
- Shampoo, soap, deodorant and other toiletries
- Some extra spending money for snacks, merch, souvenirs, money for mission offering, etc.
- Bible (with student's name and address in it) and a pen/pencil to take notes

PACKING TIPS

PACKING TIPS: HELPFUL HINTS

Our events are designed to strengthen your student's relationship with God. Please ensure they only bring clothing that is appropriate at all times. Any student wearing clothing that is deemed inappropriate by staff will be asked to change.

GIRLS' GUIDELINES

TOPS

- Tank tops and sleeveless shirts must be at least three fingers across on the shoulder.
- No shirts that show your belly button/stomach or low V-neck or scoop necks that might be revealing.
- No backless or one-shoulder shirts or "bro tanks" with large armholes.

BOTTOMS

- All shorts, skirts, dresses and rompers must be fingertip length. We have a NO ROLL rule for shorts.
- No shorts with writing across the backside.
- No shorts with holes.
- Leggings and yoga pants are acceptable ONLY if your shirt covers your backside completely.
- Pajama pants are not allowed outside of your room.

SWIMWEAR

- One-piece swimsuits are preferable; holes cut out in the middle, see-through material, strapless suits, or suits that might be revealing are not allowed.
- A tankini is acceptable if the top and bottoms touch at the waist.
- No high-cut swimsuit bottoms
- A dark-colored shirt/tank top must be worn over two-piece swimsuits where top and bottom do not touch at the waist
- Shorts and shirt must be worn over swimsuit to and from the pool & waterslides.

BOYS' GUIDELINES

TOPS

- No shirts with inappropriate language or innuendos.
- No "bro tanks" with large armholes.

SWIMWEAR

- No holes or see-through material allowed.
- Shirt must be worn with swim trunks to and from the lake area as well as to and from rec and sports areas.

BOTTOMS

- Shorts must be fingertip length. We have a NO ROLL rule for shorts.
- Shorts with holes are not acceptable.
- Shorts and pants must cover underwear at all times—no sagging.
- Pajama pants are not allowed outside of your room.

CAMP RULES

By attending this camp, your student is agreeing to obey all the camp rules listed below. If your student chooses not to obey the rules, Lakepointe reserves the right to send a student home at the parents' expense.

- **NO** student or leader is permitted to leave at anytime without permission from staff.
- **NO** guns, knives, fireworks, matches, lighters, hair clippers, etc.
- **NO** cell phones (will be taken up if seen)
- **NO** iPads or any electronic games.
- **NO** tobacco, vaping, alcohol, or drug use of any kind by a student or leader.
- **NO** riding on or in any vehicles without expressed permission of the staff.
- **NO** guys in girl's rooms; NO girls in guy's rooms.
- **NO** one is allowed in the cabin without leader supervision.
- **NO** one allowed in rooms with less than three people.
- **NO** pranks allowed (or any items that might be used for pranks. EX: shaving cream, toilet paper, etc.).
- **NO** public display of affection.
- **NO** one is allowed outside of the rooms after lights out...NO ONE!!!

ALL VALUABLES BROUGHT TO CAMP ARE THE RESPONSIBILITY OF THE STUDENT. LOST OR STOLEN ITEMS ARE NOT THE RESPONSIBILITY OF THE ENCAMPMENT OR LAKEPOINTE CHURCH.

CELL PHONES

We do not allow Middle School students to bring cell phones to camp. Cell phones today are much more than just phones used to call home. We want to do our best to protect the environment that every student will experience at camp. By not allowing phones to be brought to camp we help protect that environment. We know this means you will have less contact with your student during the week, but we ask that you trust that we will do our absolute best to help your student have the best experience possible. Our pledge to you is that we will be quick to call you if there is any sickness or injury to your student. If there is an emergency and your student needs to call you, they can come to the camp office and we will get you in touch with your student as quickly as possible. We really believe that a week away from texting and social media will do all of our students some good. Letting go of their phone will be a difficult thing for many of our students, and there will be many that will be tempted to "sneak" their phone to camp. Please make sure that you as the parent are in possession of their phone when they leave for camp so that all our students can enjoy camp without the distractions that phones can bring. If we find a phone at camp we will keep it in the camp office and you will be able to pick it up at the medicine pick-up station at your check-in campus when the students return to Lakepointe.

DIETARY GUIDELINES

Highland Lakes Camp orders their Gluten Free, Nut Free and other food allergy related items from a reputable company named Gordon Food Service.

The Dining Hall Staff at Highland Lakes are professionally trained in accordance to Food Safety in the State of Texas. The Dining Hall Staff have completed Food Safety Courses and are knowledgeable about what to do for your specific allergy, which include:

- Changing gloves between touching different food products
- Assigning one to two people to focus solely on prepping/cooking/serving a particular food need
- Having clean cooking pots/pans/fryers/utensils for making food for a food allergy

The following are some common food requests that we cater to on a regular basis:

• No Red Meat	• Gluten Free	• Vegetarian	• Nut Free	• Dairy Free	• Pescatarian
---------------	---------------	--------------	------------	--------------	---------------

**For questions or concerns contact:
Fred Ancira – HLC Food Service Director
512.287.0138**

CHECK-IN INSTRUCTIONS

Grade 7|8 check-in is Friday, May 31st

Grade 5|6 check-in is Wednesday, June 5th

- Check-in is at 11 AM at the appropriate campus
- Español Rockwall and Rockwall students will ALL check in at the Rockwall Campus.
- East Dallas, Firewheel, Forney, Mesquite, North Dallas, and North Dallas Español students will ALL check in at the Mesquite Campus located at 3540 Emporium Circle, Mesquite. ***There will be NO check-in at the other campuses.***

See attached map of each campus for where to park and enter check-in. Do not park in the coned-off areas because the buses will be loading there!

- **Leave your student's luggage in the car**
- Enter the building at the marked entrances (see attached check-in maps)
- Students will get their nametag and a wristband both of which must be worn at ALL times
- Once a student receives their nametag, proceed to the designated medicine check-in location (all medication MUST be checked in except inhalers) Please DO NOT bring over-the-counter medications. Prescription medications MUST be in original prescription bottle
- If dropping off meds, parent **must** fill out and sign a medication form
- Once medicine has been checked in (or if none) student may get their luggage, and get on their assigned bus. Bus assignment will be located on your student's nametag
- Once a student loads onto the bus, they will stay on the bus until departure, so be sure to encourage your student to use the restroom and give your goodbye hugs BEFORE they load onto the bus

***Upon return, all medications can be picked up on the deck of Pier 419 for Rockwall or at the table in front of the main entry at Mesquite**

UNITED CAMP

MIDDLE SCHOOL CHECK IN PROCEDURES AT THE MESQUITE CAMPUS





FOR STUDENTS FROM
EAST DALLAS, FIREWHEEL, FORNEY, MESQUITE,
NORTH DALLAS, & LPE-NORTH DALLAS

CHECK IN
BEGINS AT 11 AM

WHEN YOU ARRIVE:

- Park in main lot.
- Leave luggage in your vehicle.
- Enter in main foyer.
- Follow map through check in process.

TO CHECK IN:

1	Get name tag	
2	Check in medications <i>(if applicable)</i>	
3	Exit the North entrance doors, tag your luggage & load onto the bus	
	Start	
	Finish	

4 
BUSES

PARK HERE

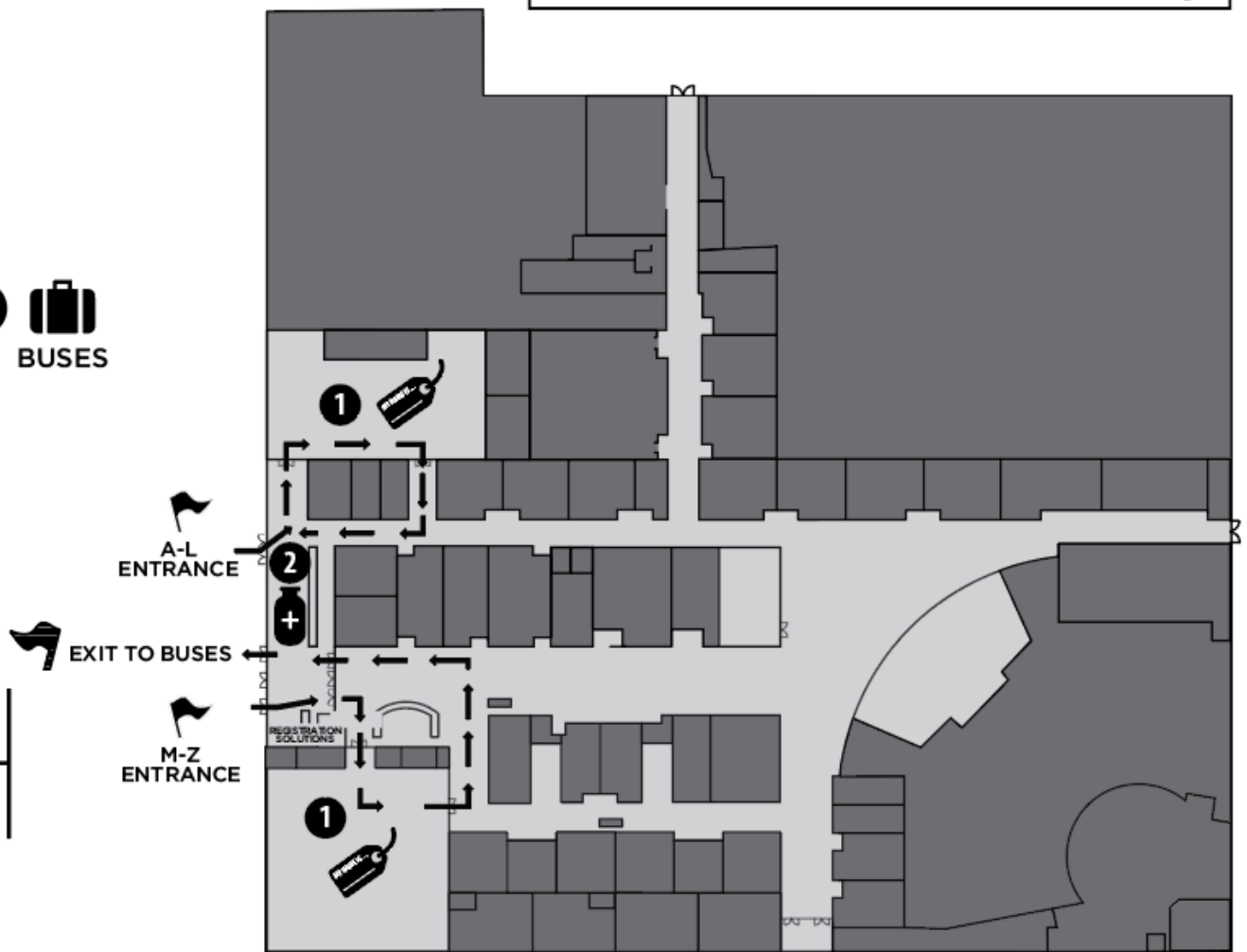

UNITED CAMP

MIDDLE SCHOOL CHECK IN PROCEDURES AT THE ROCKWALL CAMPUS

FOR STUDENTS FROM
ROCKWALL & LPE-ROCKWALL

**CHECK IN
BEGINS AT 11 AM**

WHEN YOU ARRIVE:

- Park in the South Lot.
- Leave luggage in your vehicle.
- Enter the Pier through doors specified by student's last name.
- Follow map through check in process.

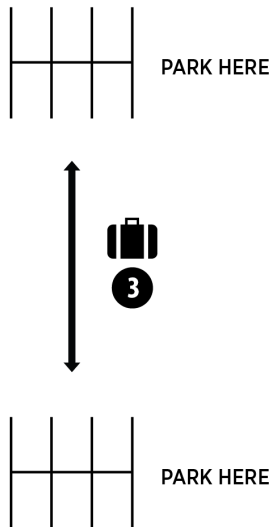

TO CHECK IN:

1 Get name tag	
2 Check in medications <i>(if applicable)</i>	
3 Grab your luggage from your car, tag it & load onto the bus	
Start	
Finish	

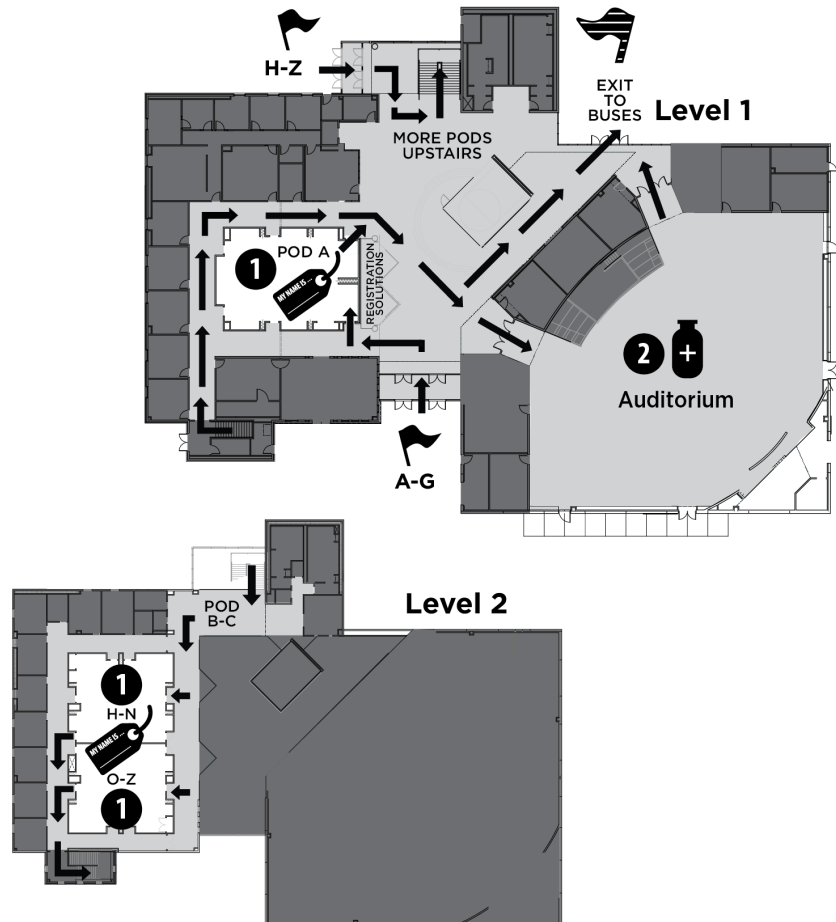

MIDDLE SCHOOL CAMP

SCHEDULE 2024

UNITED 5/6 CAMP

Day 1

11:00 AM	Check In Begins (Bring Sack Lunch)
12:00 PM	Depart LP
5:00 PM	Arrival/Unpack
5:45 PM	Dinner A
6:30 PM	Dinner B
7:00 PM	Leader Meeting
7:30 PM	Worship
8:45 PM	Group Time
9:30 PM	Late Night / Snack Shack
10:30 PM	Cabins
11:15 PM	Lights Out

Days 2 & 4

7:30 AM	Wake Up
8:00 AM	Breakfast A
8:30 AM	Breakfast B / Leader Meeting
9:15 AM	Morning Worship
10:30 AM	Group Time & Quiet Time
11:00 AM	Spirit Battle
11:15 AM	Squad Wars
12:00 PM	Lunch A
12:45 PM	Lunch B
1:30 PM	Breakouts
2:15 PM	Free Time
5:00 PM	Clean Up
5:15 PM	Dinner A
	New Believer's Class (Day 4 only)
6:00 PM	Dinner B
7:00 PM	Worship
8:15 PM	Group Time
8:45 PM	Snack Shack / Late Night
10:00 PM	Cabins
10:30 PM	Lights Out

Day 3

8:30 AM	Wake Up (Sleep-in Day)
9:00 AM	Breakfast A
9:30 AM	Breakfast B / Leader Meeting
10:15 AM	Morning Worship
11:30 AM	Group Time & Quiet Time
12:00 PM	Squad Wars
12:45 PM	Lunch A
1:30 PM	Lunch B
2:15 PM	Free Time
5:00 PM	Clean up
5:15 PM	Dinner A
6:00 PM	Dinner B
7:00 PM	Worship
8:15 PM	Group Time
8:45 PM	Snack Shack
9:15 PM	Late Night
10:00 PM	Cabins
10:30 PM	Lights Out

Day 5

7:30 AM	Wake Up / Pack & Clean Cabins
8:00 AM	Dorm Check Out Begins
8:15 AM	Breakfast A
8:45 AM	Breakfast B
9:30 AM	Campus Time
10:15 AM	Load Buses
10:45 AM	Leave
12:00 PM	Lunch on the Road
4:00 PM	Arrive at LP

MIDDLE SCHOOL CAMP

SCHEDULE 2024

UNITED 7/8 CAMP

Day 1

11:00 AM	Check In Begins (Bring Sack Lunch)
12:00 PM	Depart LP
5:00 PM	Arrival/Unpack
5:45 PM	Dinner A
6:30 PM	Dinner B
7:00 PM	Leader Meeting
7:30 PM	Worship
9:00 PM	Group Time
9:30 PM	Late Night / Snack Shack
11:00 PM	Cabins
11:30 PM	Lights Out

Days 2 & 4

7:30 AM	Wake Up
8:00 AM	Breakfast A
8:30 AM	Breakfast B / Leader Meeting
9:15 AM	Morning Worship
10:30 AM	Group Time & Quiet Time
11:00 AM	Spirit Battle
11:15 AM	Squad Wars
12:00 PM	Lunch A
12:45 PM	Lunch B
1:30 PM	Breakouts
2:15 PM	Free Time
5:30 PM	Clean Up
5:45 PM	Dinner A
	New Believer's Class (Day 4 only)
6:30 PM	Dinner B
7:30 PM	Worship
9:00 PM	Group Time
9:30 PM	Snack Shack / Late Night
11:00 PM	Cabins
11:30 PM	Lights Out

Day 3

8:30 AM	Wake Up (Sleep-in Day)
9:00 AM	Breakfast A
9:30 AM	Breakfast B / Leader Meeting
10:15 AM	Morning Worship
11:30 AM	Group Time & Quiet Time
12:00 PM	Squad Wars
12:45 PM	Lunch A
1:30 PM	Lunch B
2:15 PM	Free Time
5:30 PM	Clean Up
5:45 PM	Dinner A
6:30 PM	Dinner B
7:30 PM	Worship
9:00 PM	Group Time
9:30 PM	Snack Shack
10:15 PM	Late Night
11:00 PM	Cabins
11:30 PM	Lights Out

Day 5

7:30 AM	Wake Up / Pack & Clean Cabins
8:00 AM	Dorm Check Out Begins
8:15 AM	Breakfast A
8:45 AM	Breakfast B
9:30 AM	Campus Time
10:15 AM	Load Buses
10:45 AM	Leave
12:00 PM	Lunch on the Road
4:00 PM	Arrive at LP